

Stirlings Central

54 Sanford Street, Geraldton WA 6530

Telephone +61 8 9964 6735

stirlingscentral.com.au

Stirlings Central is a neighbourhood shopping centre located 417kms north of Perth in the Geraldton CBD. Redeveloped in 2013, the centre is anchored by Woolworths with Best & Less, Red Dot, The Reject Shop and a mix of 28 specialty stores focused on food and services. For local residents and families, Stirlings Central is a community hub that delivers a one-stop-shop for their fresh food and everyday needs.

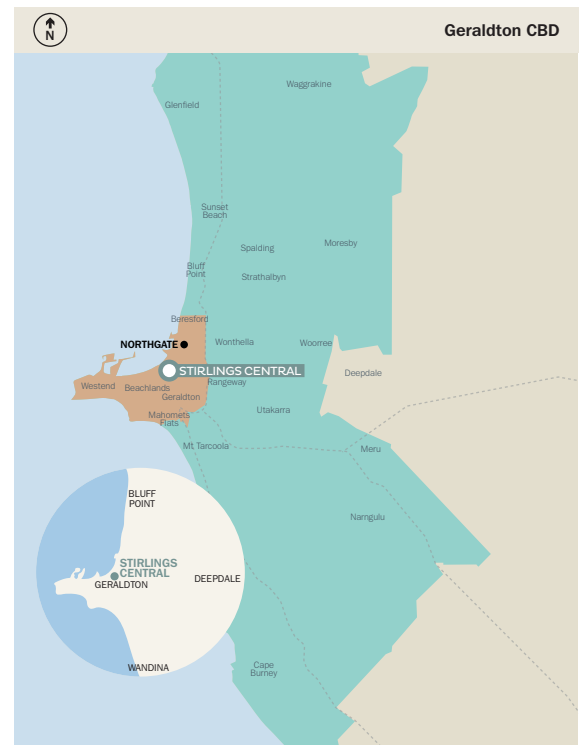

Centre statistics

Centre type	Neighbourhood
Annual traffic (million)	-
Total GLA (sqm)	8,533
Total tenants	36
Majors ¹	Woolworths
Mini Majors ²	Best & Less, Red Dot, The Reject Shop
Number of specialty retailers ³	28
Number of car spaces	147
Moving annual turnover (MAT) (\$m) ⁴	89.0
MAT/sqm – Total (\$)	10,829
MAT/sqm – Specialty (\$) ⁵	7,681

Centre statistics correct as at 31 June 2017

- Classified in accordance with SCCA guidelines, typically includes supermarkets, department stores and discount department stores. Also includes Cinemas
- Stores >400 sqm, by Sales Group
- All sales reporting tenants under 400sqm, but excludes travel agents and lotto and free standing pads sites
- Total MAT includes all reporting tenancies and is inclusive of GST, as at 31 June 2017
- MAT/sqm - Based on sales and area for all reporting tenants, non-retail tenants excluded, as at 31 June 2017

PRIMARY	● SUB REGIONAL CENTRE
SECONDARY	● NEIGHBOURHOOD CENTRE
TERTIARY	

Key statistics

35,941

RESIDENTS IN TTA

With 76% of residents Australian born



\$73,844

Average household income in the TTA



27%

Families with children



Source: Produced by Vicinity Data Science & Insights. This material is a derivative of ABS Data that can be accessed from the website of the Australian Bureau of Statistics at www.abs.gov.au.
TTA: Total Trade Area

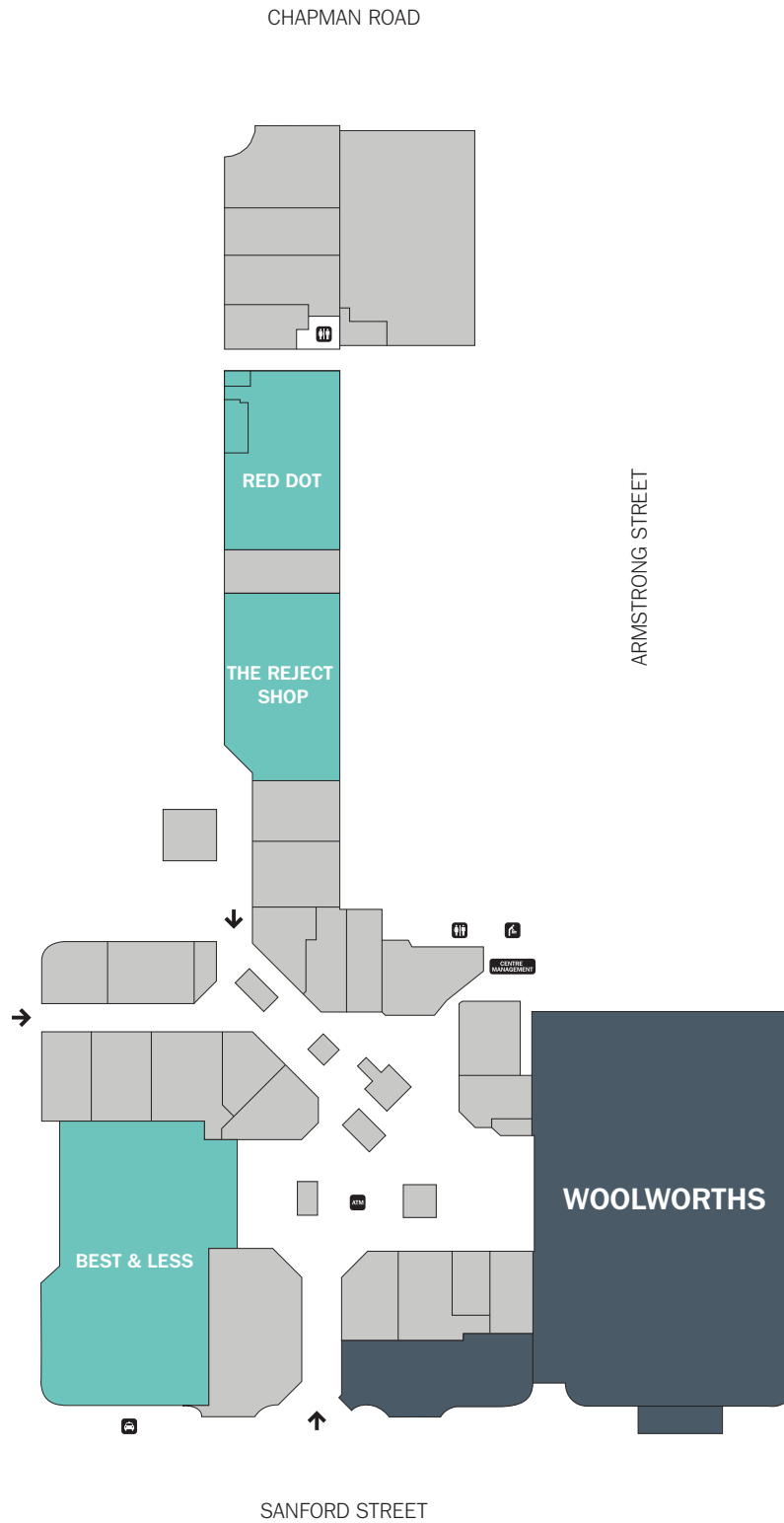

Floor plan as at July 2017.

For further information please contact:

Vicinity Centres

Level 4, Chadstone Tower One, 1341 Dandenong Road , Melbourne VIC 3148
 Telephone +61 3 7001 4000, Facsimile +61 3 7001 4001

Disclaimer
 Information contained in this document is based on historical data and is illustrative only. It does not provide any predictions as to future events or outcomes and does not constitute a lease offer or warranty as to the profitability, design or layout of the centre. You should carry out your own investigations and satisfy yourself in that regard and obtain independent legal, financial and business advice before making any decision or entering into any agreement or arrangement concerning the subject matter of this document or the centre. The information is provided on the clear understanding that while care has been taken in its preparation, to the extent permitted by law, all liability for omissions or errors however arising is expressly disclaimed. Vicinity Centres may amend, add or remove any information in this document at any time without further notice to you. You may not copy or use any part of this document without the express written consent of Vicinity Centres. Any monetary amounts are expressed in Australian dollars unless otherwise stated. Rates are subject to change without notification.